



## LDO Air Blast Head, Guard Head Installation

1. Loosen the two allen head cap screws using the allen wrench supplied with the kit. Slide the air blast cleaning head or the guard head on the sensor body.
2. Push the head onto the sensor body (Figure 1, item 3).
3. Tighten the allen head capscrews. Do not overtighten. Refer to the Air Blast manual for air hose connections, where applicable.

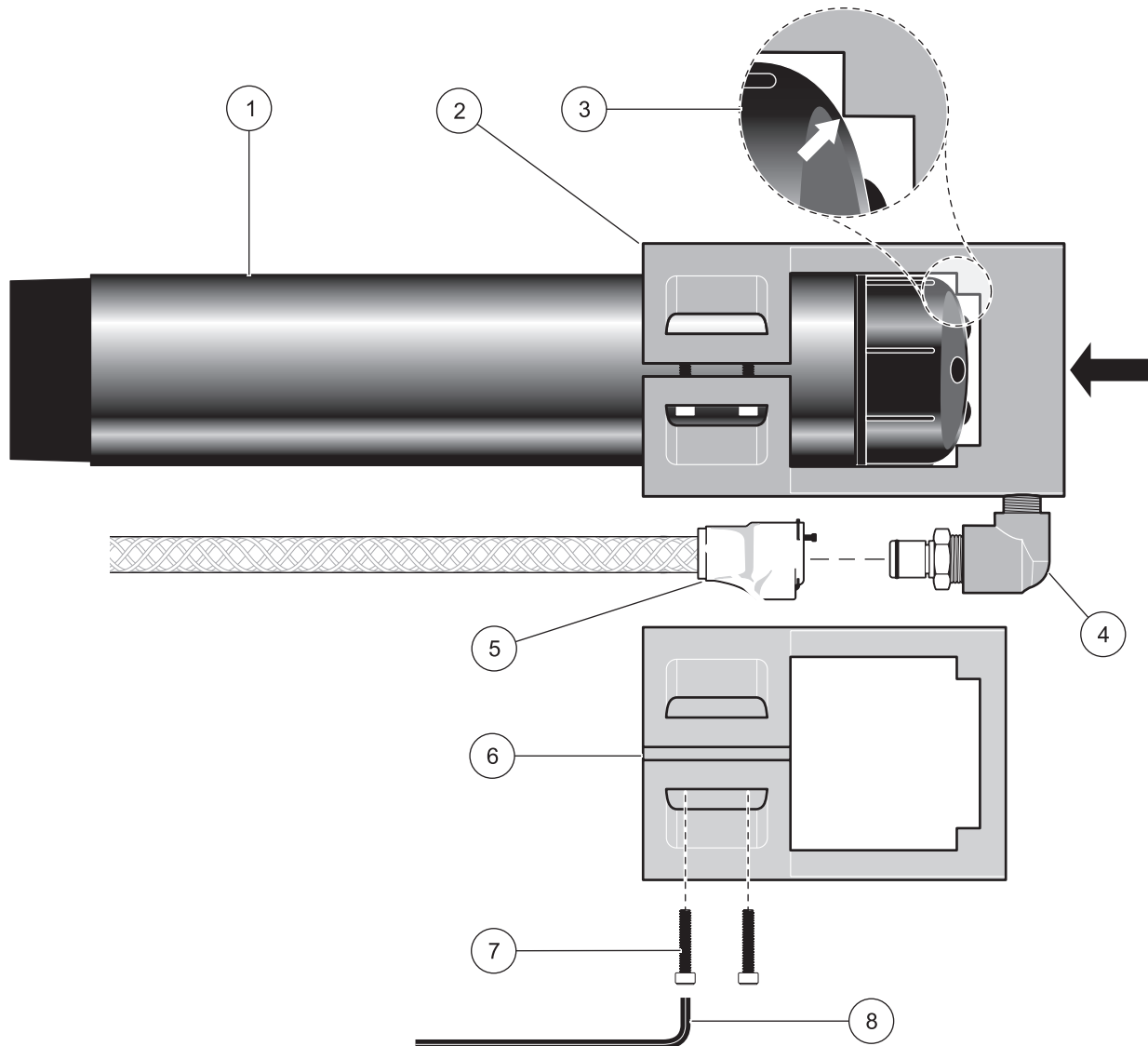

Figure 1 Air blast head and sensor guard head components

1 Sensor body	5 Air hose assembly (not supplied with kit)
2 Air blast cleaning head assembly (Cat. No. 6190250)	6 Guard head assembly (Cat. No. 6184750)
3 Assembly detail.	7 Allen head cap screw (2 assembled) 6-32x1 in. ( Cat. No. 010293)
4 Elbow (Cat. No. 6172200) with quick-connect fitting (Cat. No. 4H1314)	8 Allen wrench (Cat. No. 5134500)



FOR TECHNICAL ASSISTANCE, PRICE INFORMATION AND ORDERING:  
In the U.S.A. – Call toll-free 800-227-4224  
Outside the U.S.A. – Contact the HACH office or distributor serving you.  
On the Worldwide Web – [www.hach.com](http://www.hach.com); E-mail – [techhelp@hach.com](mailto:techhelp@hach.com)

HACH COMPANY  
WORLD HEADQUARTERS  
Telephone: (970) 669-3050  
FAX: (970) 669-2932